

Features

- High temperature soldering guaranteed
- Low leakage current
- Low forward voltage drop

HF

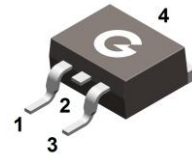
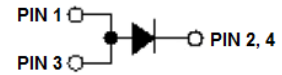

TO-263

Mechanical Data

- Case: TO-263
- Molding Compound: UL Flammability Classification Rating 94V-0
- Terminals: Matte tin-plated leads; solderability-per MIL-STD-202, Method 208

Ordering Information

Part Number	Package	Shipping Quantity	Marking Code
7.0D2PAK22	TO-263	50 pcs / Tube & 800 pcs / Tape & Reel	FZ

Maximum Ratings

 (@ T_A = 25°C unless otherwise specified)

Parameter	Symbol	Value	Unit
Peak Pulse Power (t _p = 10/1000μs)	P _{PP}	7000	W
Peak Pulse Current (t _p = 10/1000μs)	I _{PP}	180	A

Thermal Characteristics

Parameter	Symbol	Value	Unit
Junction Temperature Range	T _J	-55 ~ +175	°C
Storage Temperature Range	T _{STG}	-55 ~ +175	°C

Electrical Characteristics

 (@ T_A = 25°C unless otherwise specified)

Parameter	Symbol	Test Condition	Min.	Typ.	Max.	Unit
Reverse Stand-off Voltage	V _{RWM}		-	-	24	V
Reverse Breakdown Voltage	V _(BR)	I _T = 1mA	26.7	-	29.5	V
Reverse Leakage Current	I _R	V _{RWM} = 24V	-	-	10	μA
Clamping Voltage	V _C	I _{PP} = 180A, t _p = 10/1000μs	-	-	38.9	V

Ratings and Characteristic Curves (@ $T_A = 25^\circ\text{C}$ unless otherwise specified)

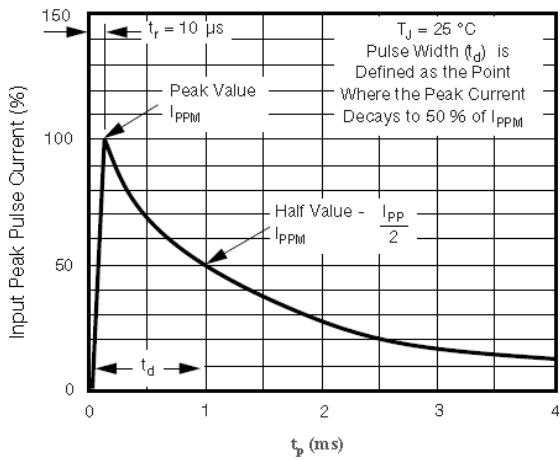

Fig 1 10/1000µs waveform per IEC61000-4-5

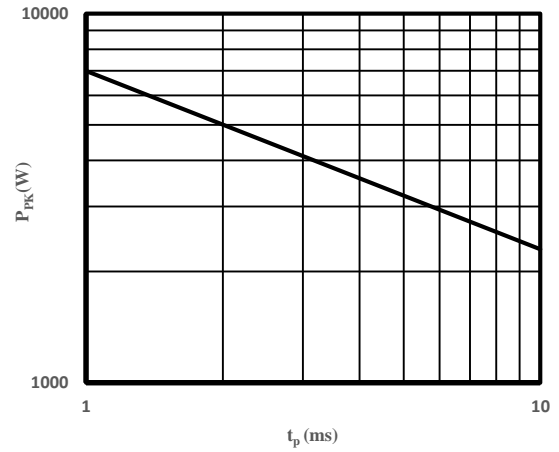

Fig 2 Peak Pulse Current Rating Curve

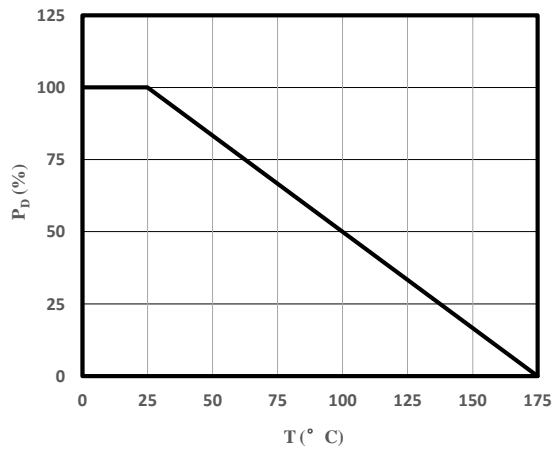
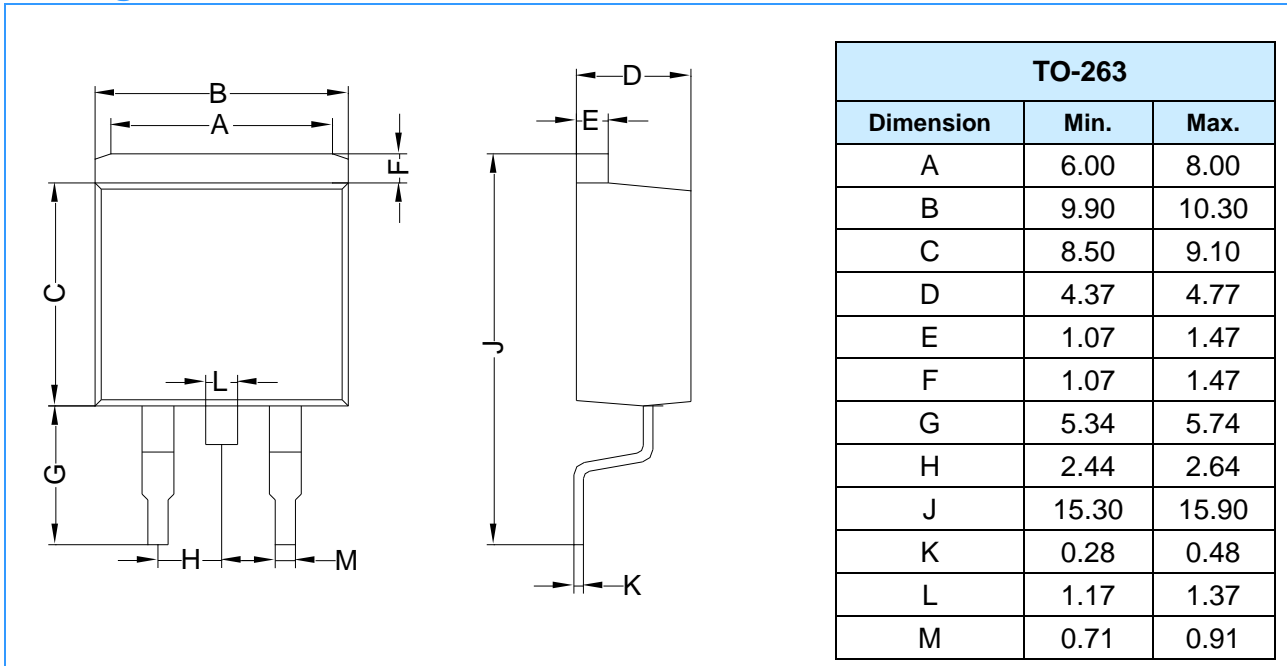
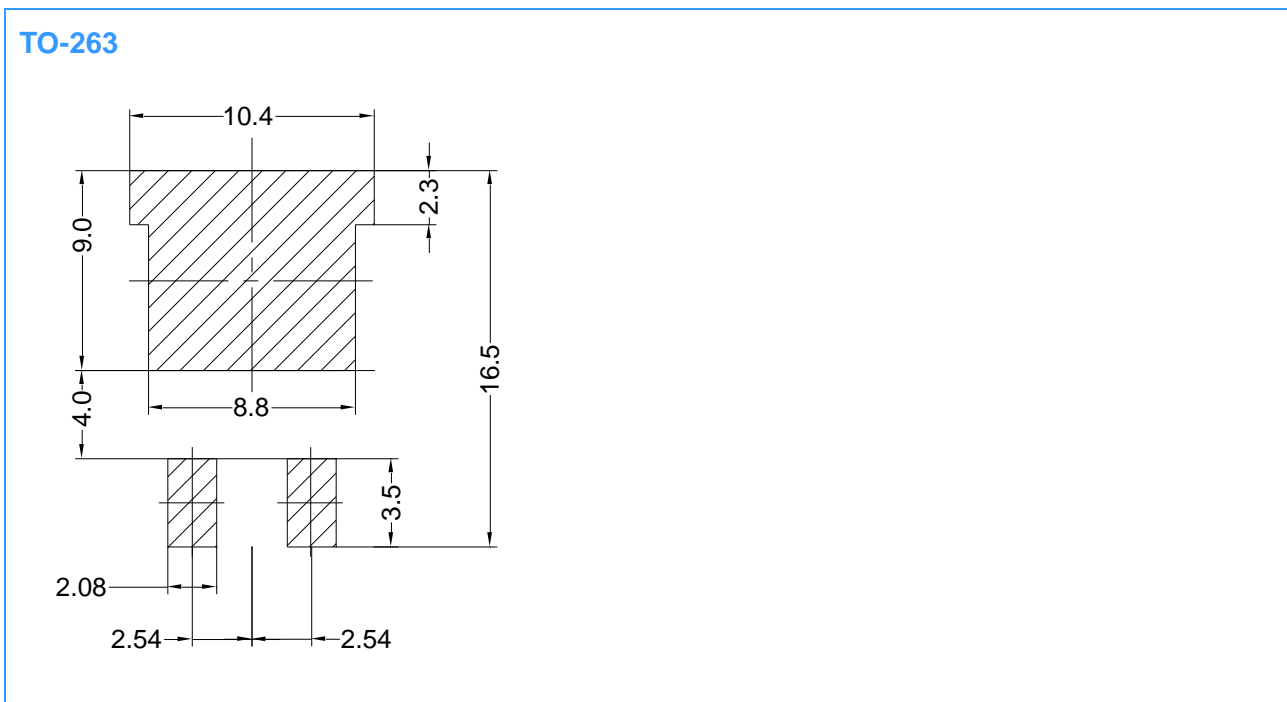

Fig 3 Power Derating Curve

Package Outline Dimensions (Unit: mm)



Mounting Pad Layout (Unit: mm)



IMPORTANT NOTICE

Changzhou Galaxy Century Microelectronics (GME) reserves the right to make changes without further notice to any product information (copyrighted) herein to make corrections, modifications, improvements, or other changes. GME does not assume any liability arising out of the application or use of any product described herein; neither does it convey any license under its patent rights, nor the rights of others.