

### Features

- High switching speed
- High breakdown voltage
- Low leakage current
- Low capacitance

HF

### Typical Applications

- Ultra high-speed switching
- Voltage clamping

### Mechanical Data

- Case: SOT-143
- Terminals: solderable per MIL-STD-202, Method 208.

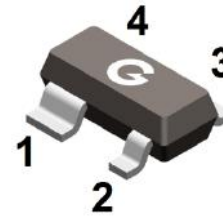
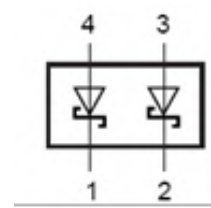

SOT-143

### Ordering Information

Part Number	Package	Shipping	Marking Code
BAS40-07	SOT-143	3000 pcs / Tape&Reel	47

### Maximum Ratings (@T<sub>A</sub>=25°C unless otherwise specified)

Parameter	Symbol	Limits	Unit
Reverse Voltage	V <sub>R</sub>	40	V
Forward Continuous Current *	I <sub>FM</sub>	200	mA
Repetitive Peak Forward Current	I <sub>FRM</sub>	120	mA
Non-Repetitive Peak Forward Current @8.3ms	I <sub>FSM</sub>	200	mA
Power Dissipation *	P <sub>d</sub>	250	mW

\* part mounted on FR-4 board with recommended pad layout

### Thermal Characteristics

Parameter	Symbol	Limits	Unit
Thermal Resistance, Junction to Ambient *	$R_{\theta JA}$	400	$^{\circ}C/W$
Operating Junction Temperature Range	$T_j$	-55 to +125	$^{\circ}C$
Storage Temperature Range	$T_{STG}$	-55 to +150	$^{\circ}C$

### Electrical Characteristics (@ $T_A=25^{\circ}C$ unless otherwise specified)

Parameter	Symbol	Conditions	Min	Typ	Max	Unit
Forward Voltage *1	$V_F$	$I_F=1mA$			0.38	V
		$I_F=10mA$			0.55	V
		$I_F=40mA$			1	V
Reverse Leakage Current *2	$I_R$	$V_R=30V$			0.2	$\mu A$
Capacitance Between Terminals	$C_T$	$V_R=0V, f=1MHz$		2.5	5	pF

\*1: pulse test,  $t_p \leq 300\mu s$

\*2: pulse test,  $t_p \leq 5ms$

### Ratings and Characteristic Curves ( $T_A=25^{\circ}C$ unless otherwise noted)

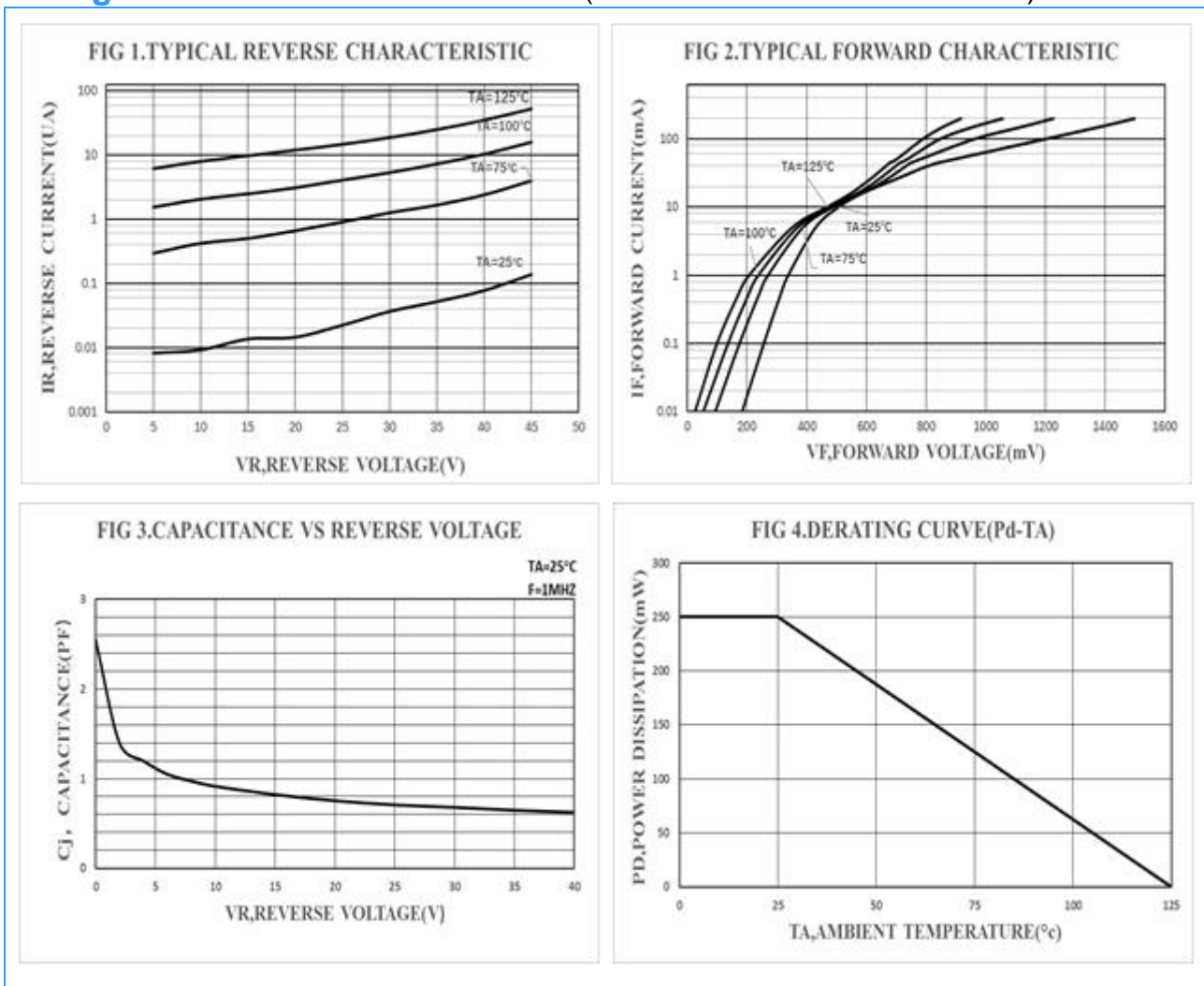

Package Outline Dimensions (unit: mm)

SOT-143

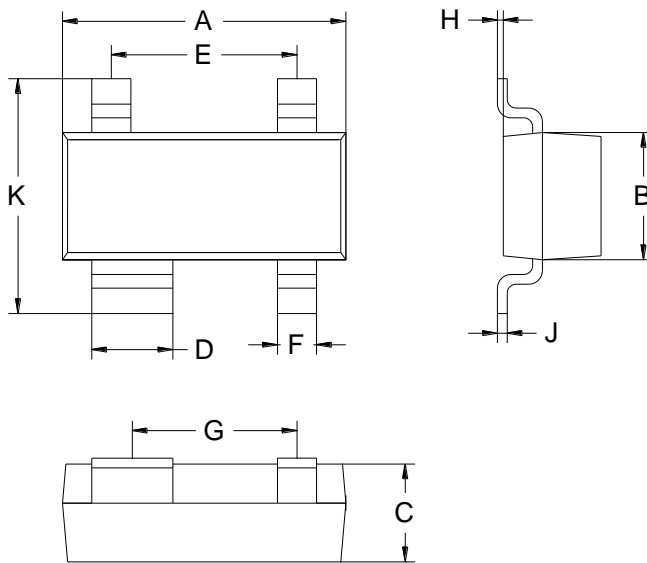

SOT-143		
Dim	Min	Max
A	2.70	3.10
B	1.10	1.50
C	0.90	1.10
D	0.78	0.88
E	1.80	2.00
F	0.37	0.43
G	1.59	1.79
H	0.02	0.10
J	0.05	0.15
K	2.20	2.60

Mounting Pad Layout (unit: mm)

SOT-143

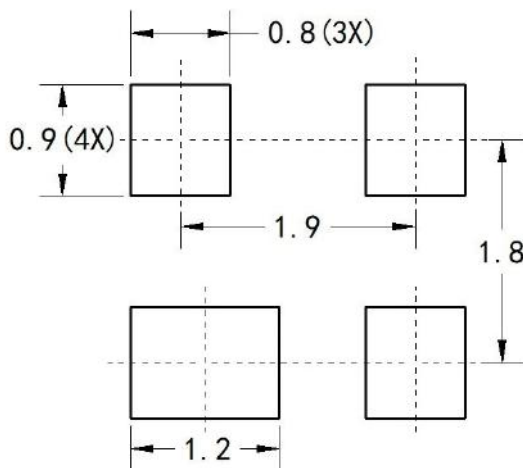

IMPORTANT NOTICE

Galaxy Microelectronics (GME) reserves the right to make changes without further notice to any product herein to make corrections, modifications, improvements, or other changes. GME does not assume any liability arising out of the application or use of any product described herein; neither does it convey any license under its patent rights, nor the rights of others.