

### Features

- Low Forward voltage drop
- High breakdown voltage
- Guard ring protected
- Low capacitance
- Very small SMD package

HF

### Typical Applications

- For high speed switching applications

### Mechanical Data

- Case: SOT-323
- Terminals: solderable per MIL-STD-202, Method 208

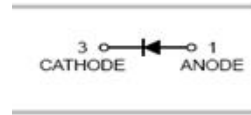

BAS70W

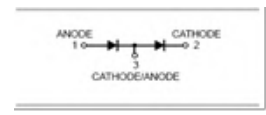

BAS70W-04

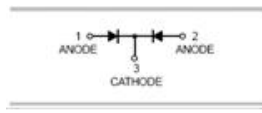

BAS70W-05

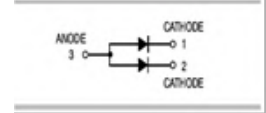

BAS70W-06



SOT-323

### Ordering Information

Part Number	Package	Shipping	Marking Code
BAS70W	SOT-323	3000 pcs / Tape & Reel	K73
BAS70W-04	SOT-323	3000 pcs / Tape & Reel	K74
BAS70W-05	SOT-323	3000 pcs / Tape & Reel	K75
BAS70W-06	SOT-323	3000 pcs / Tape & Reel	K76

### Maximum Ratings (@T<sub>A</sub>=25°C unless otherwise specified)

Parameter	Symbol	Limits	Unit
Peak Repetitive Reverse Voltage	V <sub>RRM</sub>	70	V
Working Peak Reverse Voltage	V <sub>RWM</sub>		
DC Reverse Voltage	V <sub>R</sub>		
Forward Continuous Current *	I <sub>F</sub>	70	mA
Non-Repetitive Peak Forward Surge Current@t <sub>p</sub> =8.3ms	I <sub>FSM</sub>	100	mA
Power Dissipation *	P <sub>d</sub>	200	mW

\* part mounted on FR-4 board with recommended pad layout

### Thermal Characteristics

Parameter	Symbol	Limits	Unit
Thermal Resistance, Junction to Ambient Air	$R_{\theta JA}$	500	$^{\circ}C/W$
Operating Junction Temperature Range	$T_j$	-55 to +125	$^{\circ}C$
Storage Temperature Range	$T_{STG}$	-55 to +150	$^{\circ}C$

### Electrical Characteristics (@ $T_A=25^{\circ}C$ unless otherwise specified)

Parameter	Symbol	Conditions	Min	Typ	Max	Unit
Forward Voltage *1	$V_F$	$I_F=1mA$			0.41	V
		$I_F=15mA$			1	V
Reverse Leakage Current *2	$I_R$	$V_R=50V$			100	nA
Capacitance Between Terminals	$C_T$	$V_R=0V, f=1MHz$			2	pF
Reverse Recovery Time	$t_{rr}$	$I_F=I_R=10mA, R_L=100\Omega$			5	ns

\*1: pulse test,  $t_p \leq 300\mu s$

\*2: pulse test,  $t_p \leq 5ms$

### Ratings and Characteristic Curves ( $T_A=25^{\circ}C$ unless otherwise noted)

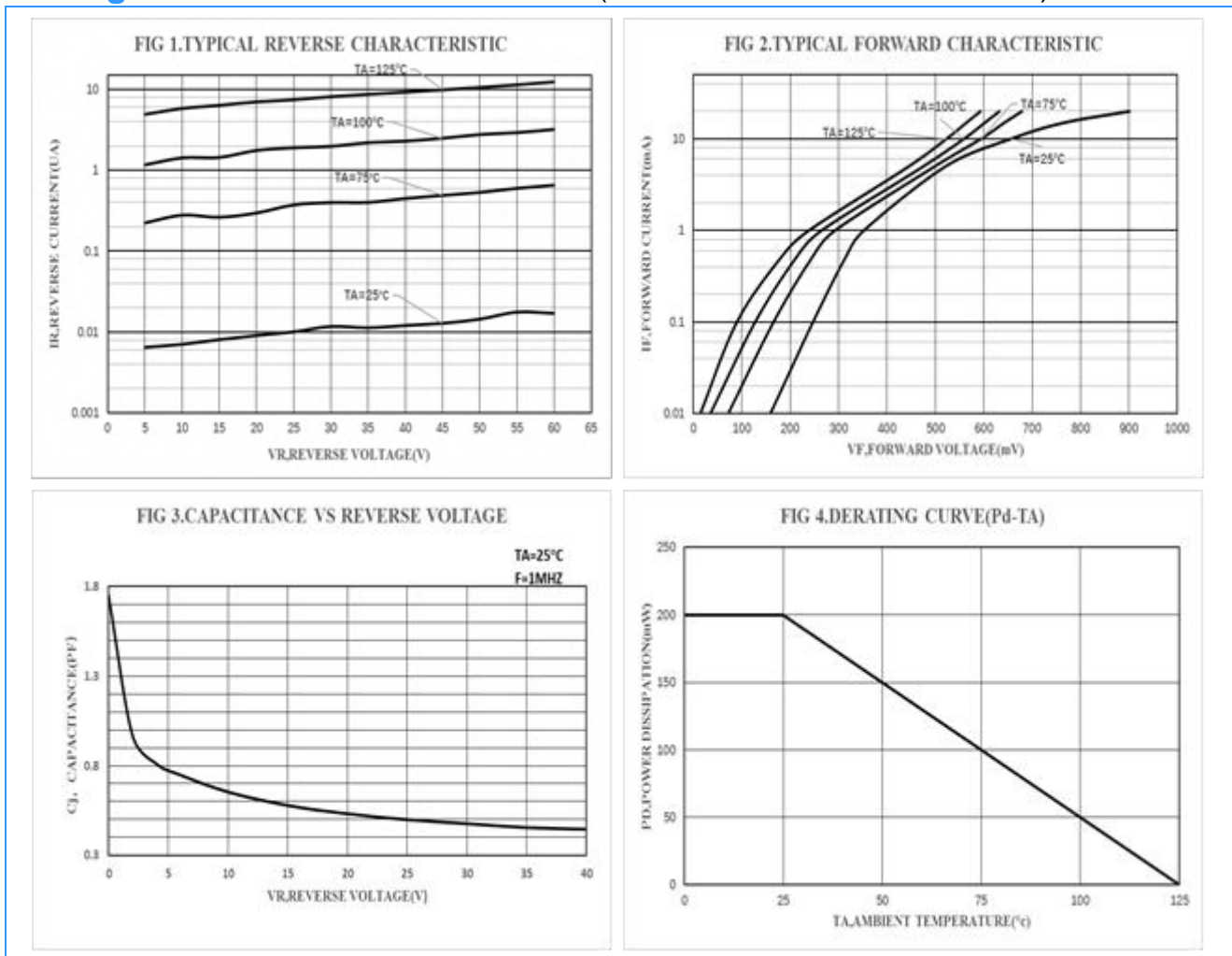

**Package Outline Dimensions**(unit:mm)

**SOT-323**

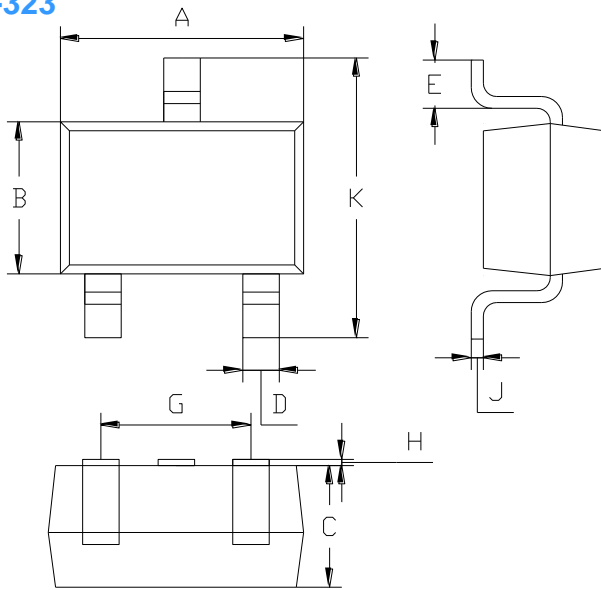

SOT-323		
Dim	Min	Max
A	1.80	2.20
B	1.15	1.35
C	0.90	1.10
D	0.15	0.35
E	0.25	0.40
G	1.20	1.40
H	0.02	0.10
J	0.05	0.15
K	2.20	2.40

**Mounting Pad Layout**(unit:mm)

**SOT-323**

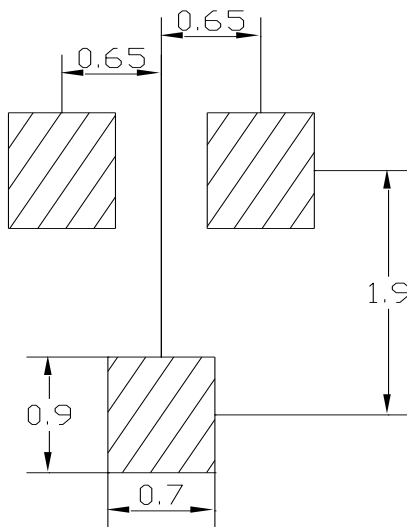

**IMPORTANT NOTICE**

Galaxy Microelectronics (GME) reserves the right to make changes without further notice to any product herein to make corrections, modifications, improvements, or other changes. GME does not assume any liability arising out of the application or use of any product described herein; neither does it convey any license under its patent rights, nor the rights of others.