

## Features

- Current Transfer Ratio  
(CTR: 50~600% at  $I_F = 5\text{mA}$ ,  $V_{CE} = 5\text{V}$ )  
(CTR: 63~320% at  $I_F = 10\text{mA}$ ,  $V_{CE} = 5\text{V}$ )
- High Isolation Voltage Between Input and Output ( $V_{iso} = 5000\text{V rms}$ )
- Wide operating temperature range:
  - BL101XG Series (Top=-55°C to 110°C)
  - BL101XHG Series (Top=-55°C to 125°C)

HF

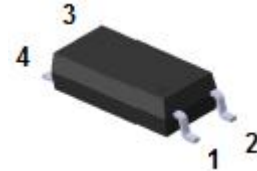
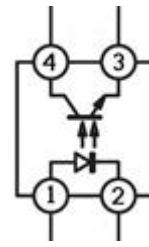

LSOP-4L

## Applications

- Programmable Controllers
- System Appliances, Measuring Instruments
- Telecommunication Equipments
- Home Appliances, Such as Fan Heaters, etc
- Signal Transmission Between Circuits of Different Potentials and Impedances

## Mechanical Data

- Case: LSOP-4L
- Molding Compound, UL Flammability Classification Rating 94V-0
- Terminals: Matte Tin Plated Leads, Solderable per MIL-STD-202, Method 208

## Ordering Information

Part Number	Package	Shipping	Marking Code
BL101X(H)G	LSOP-4L	3000 pcs / Tape & Reel	BL101X(H)

X: CTR Rank (0, 2, 3, 4, 7, 8 or 9)

H: is for Top=-55°C to 125°C.

## Maximum Ratings (@ $T_A=25^\circ\text{C}$ unless otherwise specified)

Parameter		Symbol	Value	Units
Input	Forward Current	$I_F$	60	mA
	Peak Forward Current (1us, pulse)	$I_{FP}$	1.5	A
	Reverse Voltage	$V_R$	6	V
	Power Dissipation	$P_D$	100	mW
Output	Power Dissipation	$P_C$	150	mW
	Collector Current	$I_C$	50	mA
	Collector-Emitter Voltage	$V_{CEO}$	80	V
	Emitter-Collector Voltage	$V_{ECO}$	7	V

## Thermal Characteristics

Parameter	Symbol	Values	Units
Total Power Dissipation	$P_{TOT}$	250	mW
Isolation Voltage <sup>(Note1)</sup>	$V_{ISO}$	5000	V <sub>rms</sub>
Operating Temperature	$T_{OPR}$	BL101XG	-55 to 110 °C
		BL101XHG	-55 to 125 °C
Storage Temperature Range	$T_{STG}$	BL101XG	-55 to +125 °C
		BL101XHG	-55 to +135 °C
Soldering Temperature <sup>(Note2)</sup>	$T_{SOL}$	260	°C

Notes:

1. AC for 1 minute, R.H.= 40 ~ 60% R.H. In this test, pins 1, 2 are shorted together, and pins 3, 4 are shorted together.
2. For 10 seconds.

## Electrical Characteristics-TR1 (@TA=25°C unless otherwise specified)

Parameter		Symbol	Test conditions	MIN	TYP	MAX	UNIT					
Input	Forward Voltage	BL101XG	$I_F=50mA$	-	1.30	1.5	V					
		BL101XHG		-	1.50	1.7	V					
	Reverse Current		$I_R$	$V_R=6V$	-	-	10	uA				
	Input Capacitance		$C_{in}$	$V_R=0V, f=1kHz$	-	50	-	pF				
Output	Collector-Emitter Dark Current		$I_{CEO}$	$V_{CE}=20V, I_F=0mA$	-	-	100	nA				
	Collector-Emitter Breakdown Voltage		$BV_{CEO}$	$I_C=0.1mA$	80	-	-	V				
	Emitter-Collector Breakdown Voltage		$BV_{ECO}$	$I_E=0.1mA$	7	-	-	V				
Transfer Characteristics	Current Transfer Ratio	BL1010(H)G	CTR	$I_F=5mA, V_{CE}=5V$	50	-	600	%				
		BL1017(H)G			80	-	160					
		BL1018(H)G			130	-	260					
		BL1019(H)G			200	-	400					
	Current Transfer Ratio	BL1012(H)G	CTR	$I_F=10mA, V_{CE}=5V$	63	-	125	%				
		BL1013(H)G			100	-	200					
		BL1014(H)G			160	-	320					
		BL1012(H)G			22	-	-					
	Current Transfer Ratio	BL1013(H)G	CTR	$I_F=1mA, V_{CE}=5V$	34	-	-	%				
		BL1014(H)G			56	-	-					
		Collector-Emitter Saturation Voltage			$V_{CE(sat)}$	$I_F=10mA, I_C=1mA$	-		-	0.3	V	
		Isolation Resistance			$R_{IO}$	$V_{IO}=500Vdc, 40\sim60\%$ R.H.	$5 \times 10^{10}$		-	-	$\Omega$	
Floating Capacitance		$C_{IO}$	$V_{IO}=0, f=1MHz$	-	-	1.0	pF					
Turn On Time		$T_{on}$	$V_{CE}=5V$ $I_C=5mA$ $RL=100\Omega$	-	4	-	us					
Turn Off Time		$T_{off}$		-	3	-						
Rise Time		$t_r$		-	-	18		us				
Fall Time		$T_f$	-	-	18							

Ratings and Characteristic Curves ( $T_A=25^\circ\text{C}$  unless otherwise noted)

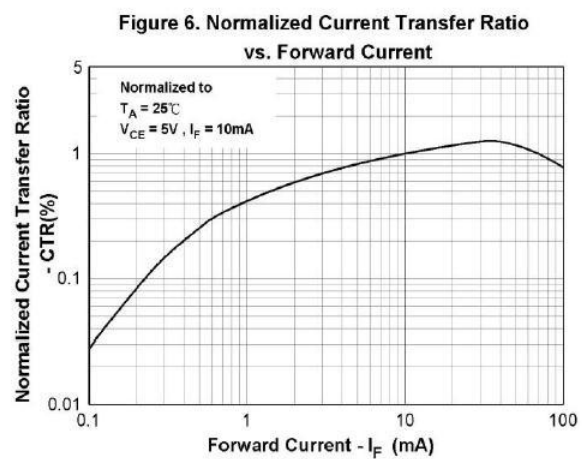
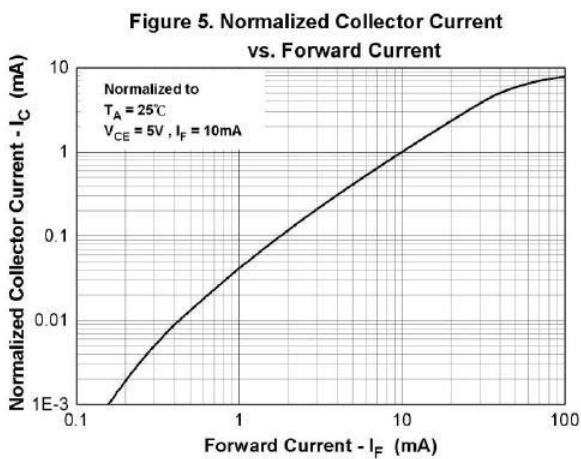
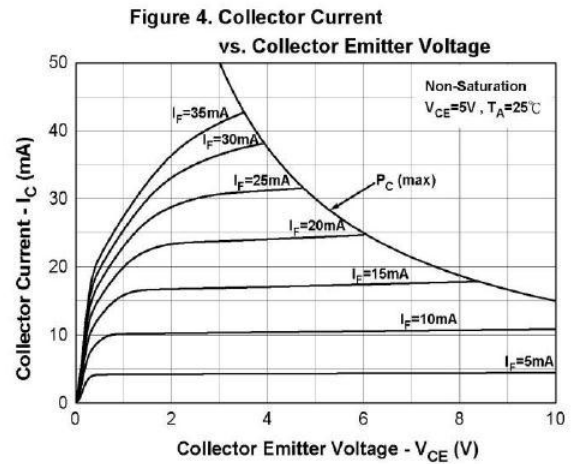
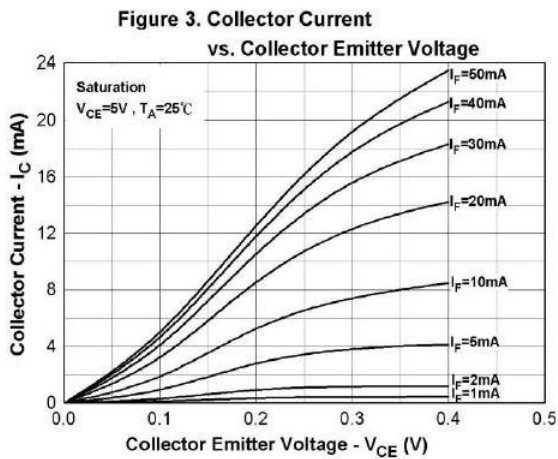
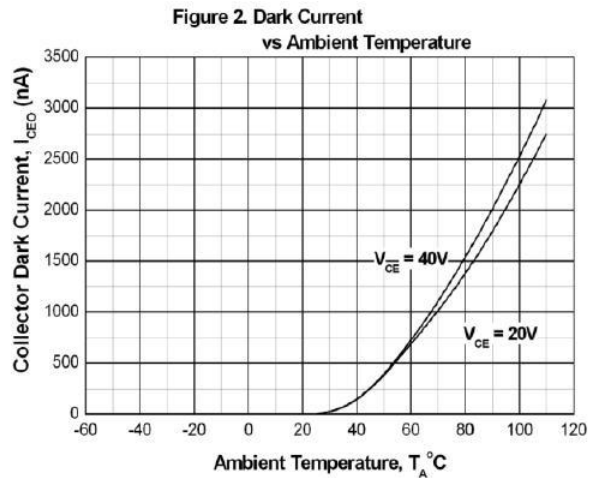
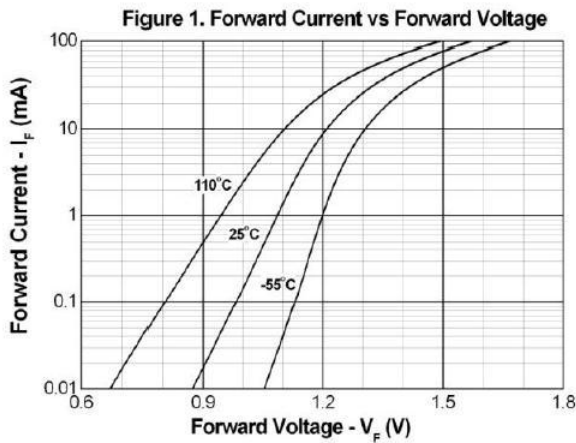

Figure 7. Normalized Current Transfer Ratio vs. Ambient Temperature

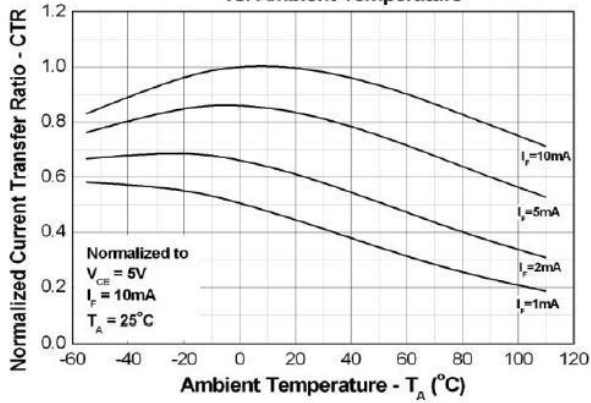

Figure 8. Normalized Current Transfer Ratio vs. Ambient Temperature

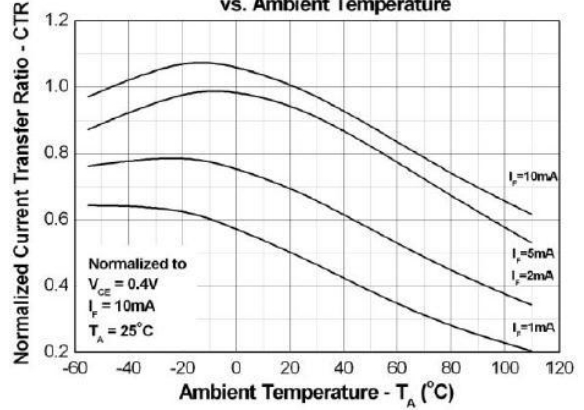

Figure 9. Turn on/off Time vs. Collector Current

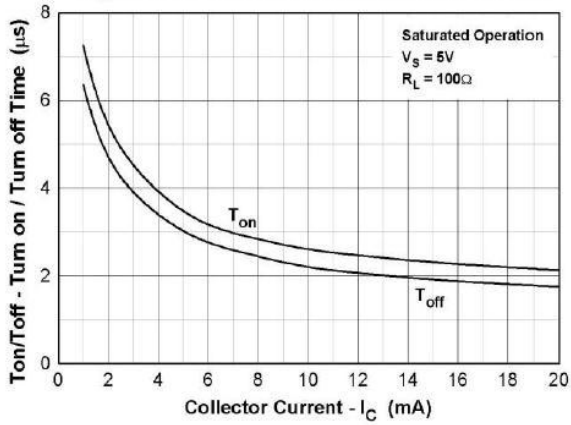
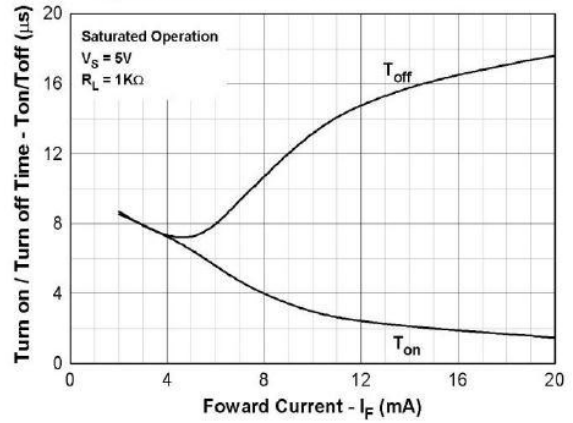
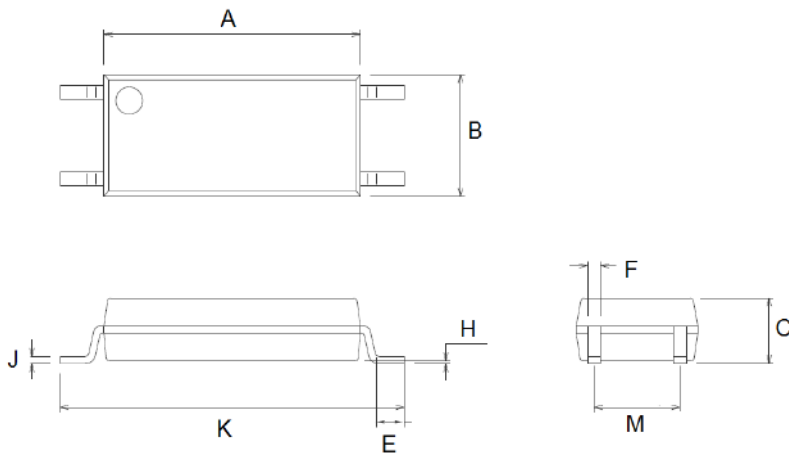

Figure 10. Turn on/off Time vs. Forward Current



## Package Outline Dimensions (unit: mm)

### LSOP-4L



LSOP-4L		
Dim	Min	Max
A	7.40	7.80
B	3.40	3.80
C	1.90	2.10
E	0.45	0.65
F	0.30	0.50
H	0.02	0.15
J	0.15	0.35
K	9.90	10.50
M	2.44	2.64

## SOLDERING FOOTPRINT (unit: mm)

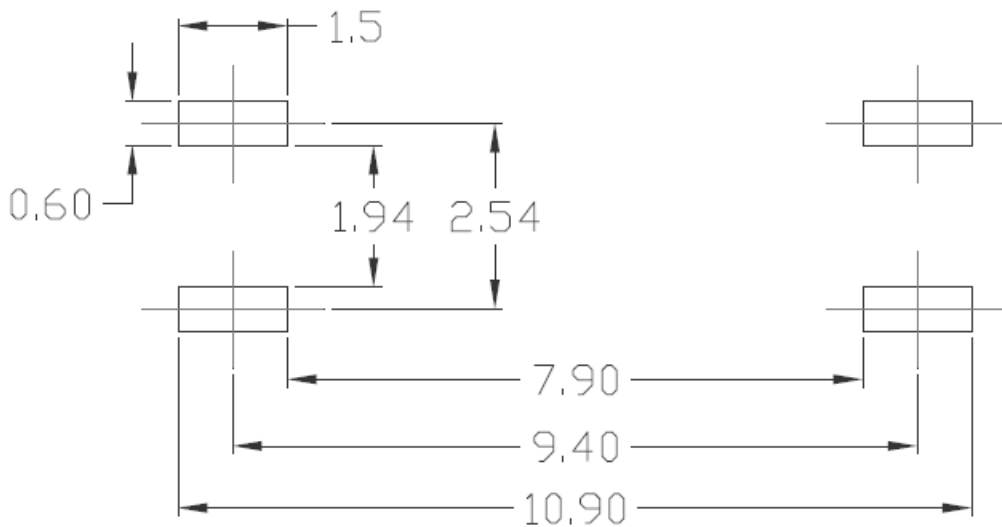

## IMPORTANT NOTICE

Galaxy Microelectronics (GME) reserves the right to make changes without further notice to any product herein to make corrections, modifications, improvements, or other changes. GME does not assume any liability arising out of the application or use of any product described herein; neither does it convey any license under its patent rights, nor the rights of others.